

LED Blinker MODUL ELLIPSOID

FEATURES

- E-marked according to ECE-R50
- Operating temperature -25°C to +50°C
- Storage temperature -40°C to +65°C
- Operating voltage 12V-14V DC
- Horizontal mounting

APPLICATION

- Front direction indicator
- Rear direction indicator

DESCRIPTION

SHIN YO LED flasher MODUL ELLIPSOID with 3 very bright SMDs, E-examined
Very unobtrusive and tinted plastic body with SMD LED technology.

This hard-wearing and powerful LED technology with specially adapted lens is brighter than normal LEDs with the same power consumption and allows an extremely small and flat design.



Wire color	Wire length	Function	Dia
black	400 ± 20mm	ground (-)	AWG26
yellow	400 ± 20mm	indicator (+)	AWG26

DIMENSION (mm)

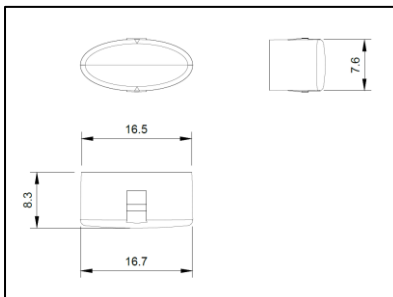

MARKING

- E24, 50R-00211, EC-MI012LED

ORDERING INFORMATION

PART NO.	PARTS PER UNIT	PACKAGE	DESCRIPTION
204-113	2pcs (1 pair)	SHIN YO blister with polybag	

FUNCTION	Nominal Voltage	Current	Power	DESCRIPTION
Indicator	13,5V	0,10A ± 15%	1,4W ± 15%	